

CURRICULUM VITAE
GAROUFALIA SKARPA
CIVIL ENGINEERING TECHNICIAN
SEPTEMBER 2020

EDUCATION:

Diploma
Civil Engineer Technician
Bachelor's Degree, Department Of Civil Engineering
Piraeus University of Applied Sciences
www.teipir.gr/index.php/el/departments-3/stef/pde
Graduated Thesis in Architecture, Title of Thesis: "Traditional Village in Naxos", Supervisor: A. Maragakis

LANGUAGES:

Languages	Level	Diploma
Greek	Native	
English	Very Good	First Certificate in English, University of Cambridge
Italian	Good	Medio, Exams Palso
Γερμανικά	Good	3 years course level

SOFTWARE:

- Fluent knowledge AUTOCAD v.13 (2D)
- Fluent knowledge Key 2013 v.1.70Q (Reinforcement program in AUTOCAD v.13)
- Working knowledge Microsoft Office 2013 (Word 2013 – Excel 2013)

PROFESSIONAL EXPERIENCE:

Collaboration with the following companies

Date	Company
01/09/2015 – today	OMIKRON KAPPA CONSULTING S.A. (www.omikronkappa.gr)
15/12/2013 – 05/05/2015	KANON CONSULTING S.A. (www.kanon.com.gr)
01/01/2006 – 30/11/2013	ODOTECHNIKI LTD (www.odotechniki.gr)
01/12/2000 – 31/12/2005	COMPUTATIONAL DESIGN LTD (www.ypologistiki.gr)
01/08/1995 – 30/11/2000	AMTE S.A. (www.amte.gr)

RESPONSIBILITIES:

- Head of the drawing department.
- Work both independently and as part of a team.
- Collaboration with survey, transportation, geotechnical, hydraulic, mechanical, electrical engineers and architects for the management of various types of projects taking into account the requirements of all the components of a project design.
- Responsible for the conceptual, preliminary and final construction drawings, using Autodesk's Autocad software, key and Microsoft Office.

DUTIES:

- Bill of Quantities (BoQ).
- Drawings of infrastructure and building projects in Conceptual, Preliminary, and Final design stages.
- Drawings of general arrangement (plan-views, elevation views, transverse and longitudinal sections, excavating diagrams, foundation, prestress, construction phases, details).
- Drawings of structural and geotechnical design of infrastructure projects (Retaining walls, culverts, pile walls, bridges made of reinforced or prestressed concrete, precast or cast in situ, composite bridges, road, railway or pedestrian bridges, Cut & Covers, temporary support or final lining of tunnels, retrofit or interventions on existing structures).
- Drawings of structural design of buildings (industrial, residential, commercial, offices, chimneys, stadia).
- Drawings of reinforcement arrangement based on the results of the analysis.
- Best reinforcement arrangement aiming at minimum waste and cost.
- Layout and reinforcement anchorage details according to DIN regulations, DIN FACHBERICHTE, Eurocodes and Greek regulations (EKOS2000).
- Bar Bending Schedule (BBS).

SEMINAR:

Fachhochschule Hildesheim/Holzminden/Göttingen, Germany, 1998.

Civil Engineering Technology/Technician

“MSc Management in Construction European Intensive Programme”

- Cultural Differences
- Environment and Construction
- Legal Regulations and Safety
- Procurement and Construction Organisation
- Cost, Pricing, Tender
- Project Organisation
- Collaboration
- Future in Construction

REPRESENTATIVE PROJECTS

Country	Date	Name and description of the project and duties
GREECE (OMIKRON KAPPA CONSULTING S.A.)	2018-2019	Mumbai Metro (Final design stage). Arrangement of reinforcement based on the results of the analysis, Reinforcement drawings and BBS for the following stations and subways: <ul style="list-style-type: none"> • BANDRA (BKC) • SANTA CRUZ
GREECE (AECOM S.A.)	2018	OSE (HELLENIC RAILWAYS ORGANISATION) <ul style="list-style-type: none"> • OVERPASS OE1 (ROAD) AT CH. 1+922.65 • OVERPASS OE2 (ROAD) AT CH. 1+965.50 • OVERPASS OE8 (ROAD) AT CH. 15+853.22 • OVERPASS SE1 (TRAIN) AT CH. 44+709.02 • OVERPASS SE2 (TRAIN) AT CH. 44+709.02 Arrangement of reinforcement based on the results of the analysis, Reinforcement drawings and BBS.
GREECE (SALFO & ASSOCIATES S.A.)	2018	QATAR FOUNDATION STADIUM PROJECT MAIN WORKS (DESIGN AND BUILD) Arrangement of reinforcement based on the results of the analysis, Reinforcement drawings and BBS

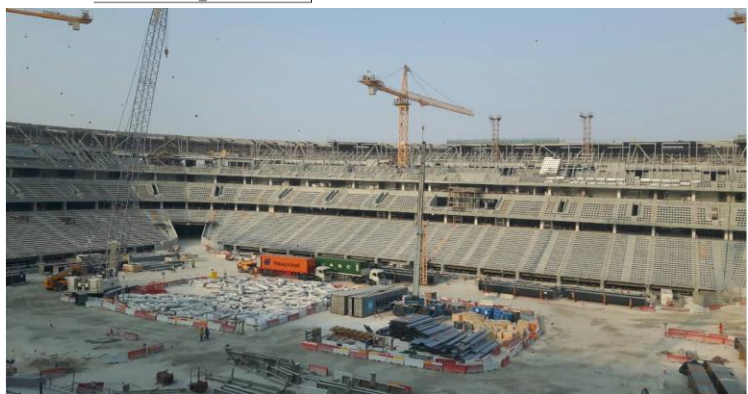
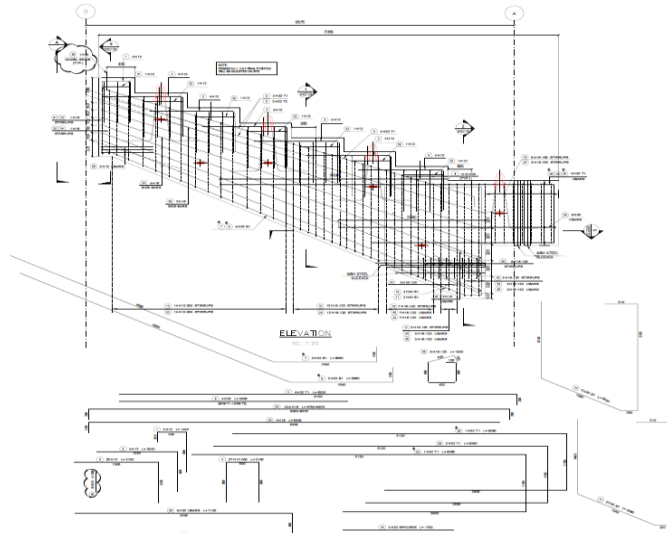

Country	Date	Name and description of the project and duties
GREECE (OMIKRON KAPPA CONSULTING S.A.)	2016-2018	<p>Doha Metro: Gold Line Underground (Final design stage). Arrangement of reinforcement based on the results of the analysis, Reinforcement drawings and BBS for the following stations and subways:</p> <ul style="list-style-type: none"> • Al Aziziyah • Qatar National Museum • Ras Bu Abboud Station and Subway • Stabling Yard • Al Waab

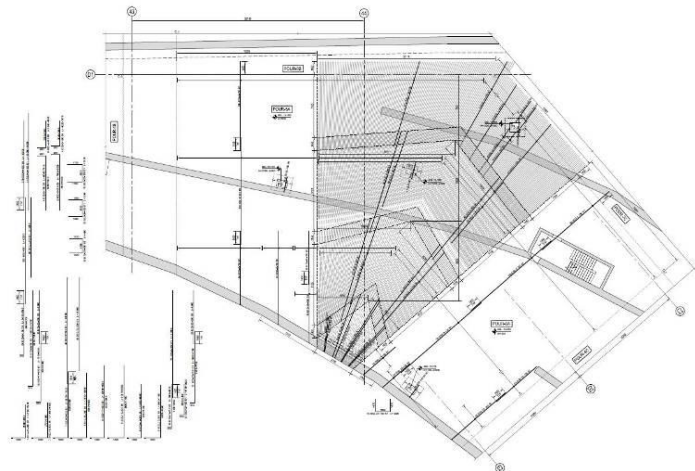

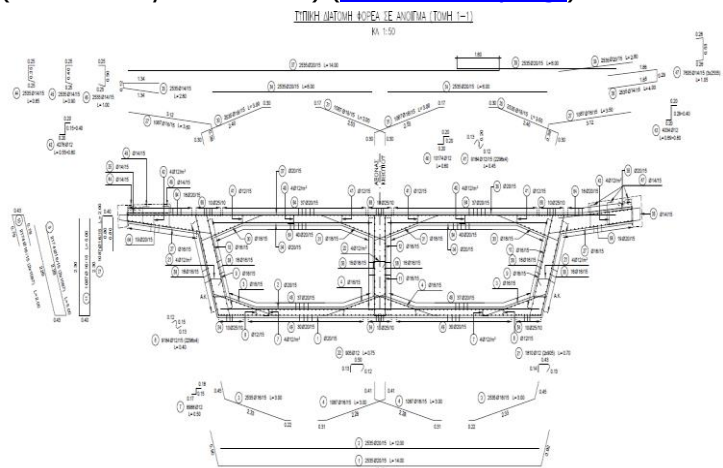

GREECE (ODOTECHNIKI LTD)	2015-2016	<p>Road Axis Lamia – Itea – Antirrio, section Bralos – Amfissa. Subsection 2. Final design of bridge 8, CH. 29+523.69 General arrangement, prestress and reinforcement drawings (For Obermeyer Hellas Ltd) (www.obermeyer.gr).</p>
-----------------------------	-----------	--



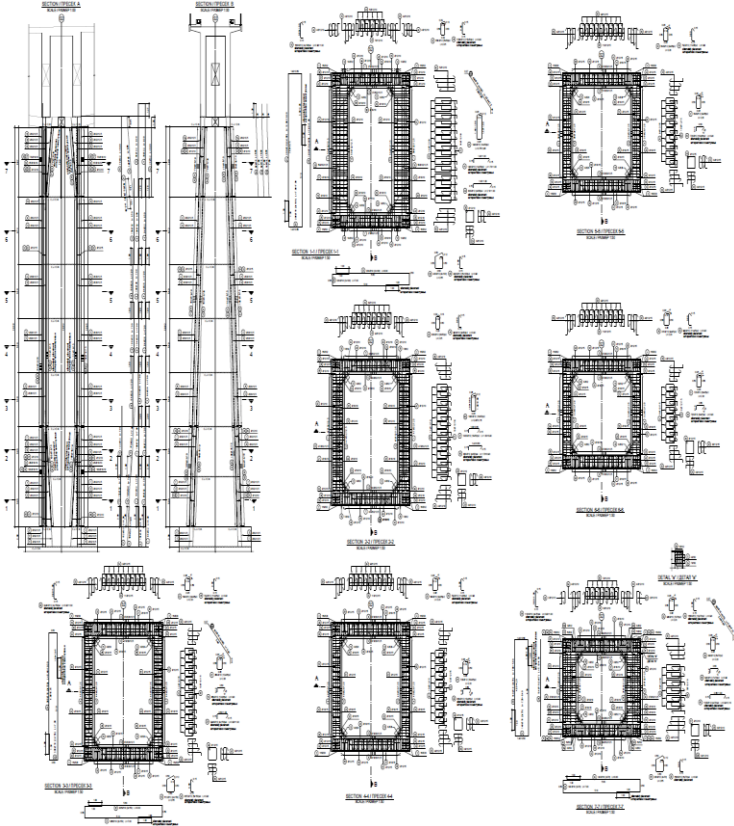

REPRESENTATIVE PROJECTS (CONTINUED)

Country	Date	Name and description of the project and duties
GREECE (AECOM S.A.)	2015-2016	<p>Egnatia Odos Highway, Section 70.2.2 (Final design stage).</p> <ul style="list-style-type: none"> G4 Bridge CH. 7+444.00. Conceptual and Final design of a four-span prestressed concrete box section bridge of 128m length. G11 Bridge CH. 14+265.45. Conceptual and final design of a four-span prestressed concrete box section bridge of 150m length. <p>Arrangement of reinforcement based on the results of the analysis, Reinforcement drawings and BBS.</p>
GREECE (ODOTECHNIKI LTD)	2015	<p>Rail Corridor VIII, Second Section Beljakovce – Kriva Palanka FUROM – (Public Enterprise Macedonian Railway Infrastructure). Detailed Design – Design of bridges</p> <p>General arrangement, prestress and reinforcement drawings (For Obermeyer Hellas Ltd)</p> 
GREECE (AECOM AE)	2015	<p>Detailed design of the first segment of Kitgum House Flyover Kampala Flyover Construction and Road Upgrading project – Uganda National Roads Authority (UNRA).</p> <p>Arrangement of reinforcement based on the results of the analysis, Reinforcement drawings and BBS.</p>
GREECE (KANON CONSULTING S.A.)	2014-2015	<p>Olympia Odos Concession Company S.A. Elefsina-Korinthos-Patra-Pyrgos-Tsakona Motorway Section GU 31N.</p> <p>The project included the final design and construction drawings underpasses, retaining walls and culverts.</p> <p>Arrangement of reinforcement based on the results of the analysis, Reinforcement drawings and BBS.</p>
GREECE (KANON CONSULTING S.A.)	2014	<p>Airport in Chania, Crete.</p> <p>Structural design of retaining walls of the surrounding area</p> <p>Arrangement of reinforcement based on the results of the analysis, Reinforcement drawings and reinforcement tables.</p>

REPRESENTATIVE PROJECTS (CONTINUED)

Country	Date	Name and description of the project and duties
GREECE (KANON CONSULTING S.A.)	2014	<p>«Completion of Afchin Agkathias – Chamezi – Siteia».</p> <p>Curved bridge, with a total length of over 840.00m and twenty one spans. As the initial Contractor had not completed the project, the construction of the remaining A2 abutment, the completion of the M19 & M20 piers and the construction of the superstructure between pier M10 and abutment A2 were assigned.</p> <p>Arrangement of reinforcement based on the results of the analysis, Reinforcement drawings and BBS tables.</p>
		
GREECE (ODOTECHNIKI LTD)	2011-2014	<p>Project Construction "Rehabilitation Works on the problematic sections of N.R. Tripoleos – Kalamata in the section: Paradisia – Tsakona", Peloponnese.</p> <p>Foundation of temporary towers and scaffolding for the erection of the Arched Bridge T4.</p> <p>Head of the drawing department.</p> <p>General arrangement and reinforcement drawings of the structural design. Drawings of the geotechnical design.</p>
		
GREECE (ODOTECHNIKI LTD)	2013	<p>«Ring road of Kotronas in Peloponnese».</p> <ul style="list-style-type: none"> • Overpass of length 14.50m at CH. 0+840.00. • Bridge of length 34.00m at CH. 2+400.00. <p>(Conceptual, preliminary and final design stage)</p> <p>Head of the drawing department.</p> <p>General arrangement and reinforcement drawings of the structural design.</p>
GREECE (COMPUTATIONAL DESIGN LTD)	2011-2013	<p>West Axis at limits of Region of Western Macedonia – Design for the Improvement of Road Florina – Antartiko – Prespes.</p> <p>The structural design of the project includes 17 valley bridges. All bridges are precast – prestressed concrete beam structures of total lengths between 80m and 130m.</p> <p>General arrangement and reinforcement drawings.</p>

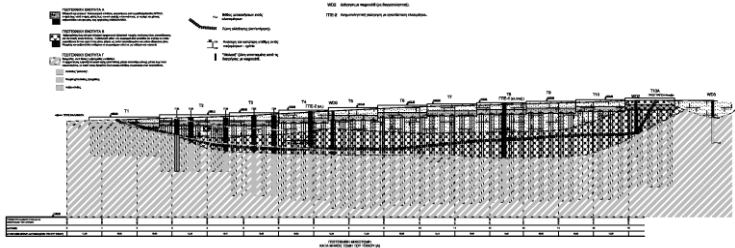
REPRESENTATIVE PROJECTS (CONTINUED)

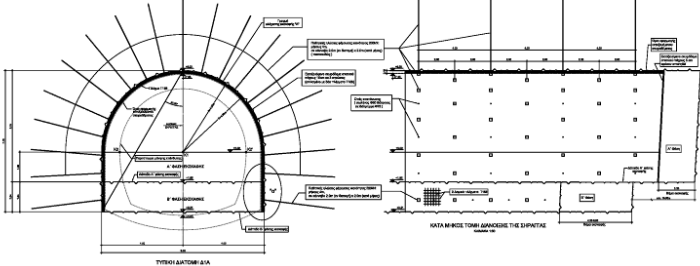
Country	Date	Name and description of the project and duties
GREECE (ODOTECHNIKI LTD)	2012	<p>Rehabilitation of the old Megalopoli – Kalamata highway to exit Derveni village. Design of landslide rehabilitation (Final design stage). Head of the drawing department. General arrangement and reinforcement drawings of the structural design. Drawings of the geotechnical design.</p> 
GREECE (ODOTECHNIKI LTD)	2010-2012	<p>Highway Igoumenitsa – Preveza. Improvement of sections. Subsection 05. Preliminary and final design of a bridge at CH. 6+245.65 Head of the drawing department. General arrangement and reinforcement drawings of the structural design. Drawings of the geotechnical design.</p>
GREECE (ODOTECHNIKI LTD)	2011	<p>New dam of Asopos river in Peloponnese. Final design of the diversion tunnel. Head of the drawing department. General arrangement and reinforcement drawings of the structural design. Drawings of the geotechnical design.</p>  

REPRESENTATIVE PROJECTS (CONTINUED)

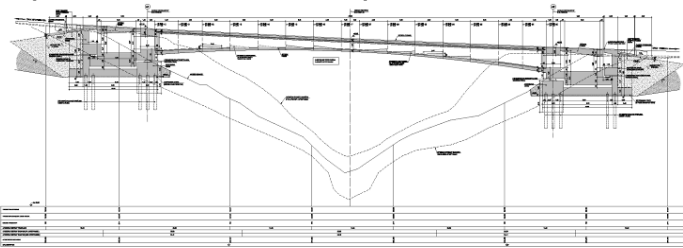
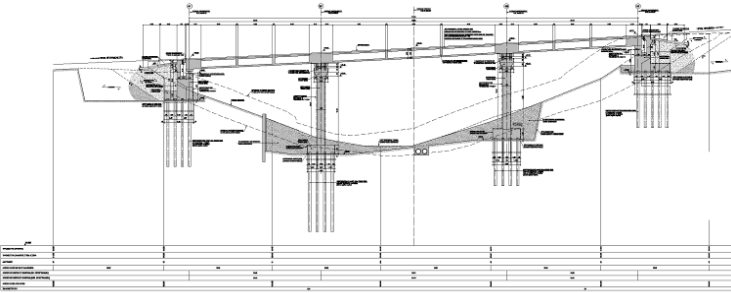
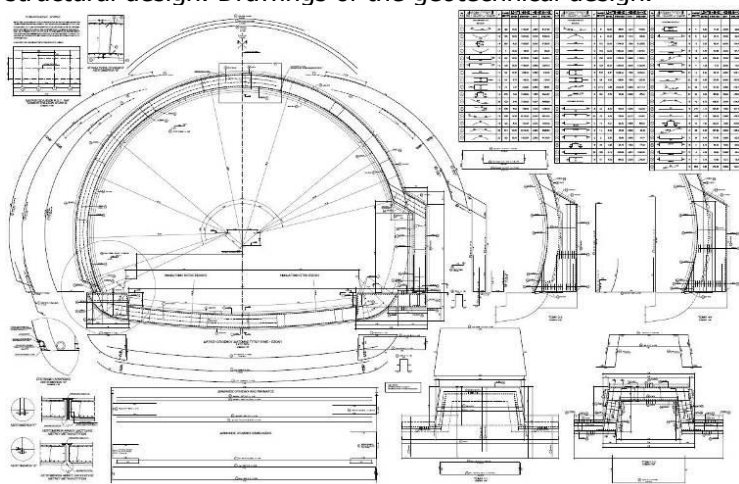
Country	Date	Name and description of the project and duties
GREECE (ODOTECHNIKI LTD)	2010	<p>Highway Igoumenitsa – Preveza. Improvement of sections. Subsection 01.</p> <ul style="list-style-type: none"> Preliminary and final design of a bridge at CH. 6+245.65. (Balanced cantilever method).  <ul style="list-style-type: none"> Preliminary design of a bridge at CH. 2+369.02 (prestressed deck).  <p>Head of the drawing department. General arrangement drawings of the structural design.</p>
GREECE (ODOTECHNIKI LTD)	2009	<p>Final geological, geotechnical, hydraulic and structural design of the "Pefka" tunnel (1st subsection) and of the C&C "Triadio A" (2nd subsection) of the outer ring road of Thessaloniki. Cut & Covers and tunnels (final design)</p> <p>Head of the drawing department. General arrangement and reinforcement drawings of the structural design. Drawings of the geotechnical design.</p> 
GREECE (ODOTECHNIKI LTD)	2009	<p>Highway Tripoli – Kalamata, section: Athineo – Lefktro, Peloponnese.</p> <p>Wall of right branch (next to the bridge of left branch) from CH. 1+895.27 to CH. 2+046.98. (final design stage)</p> <p>Head of the drawing department. General arrangement and reinforcement drawings of the structural design.</p>

REPRESENTATIVE PROJECTS (CONTINUED)

Country	Date	Name and description of the project and duties
GREECE (SALFO & ASSOCIATES S.A.)	2008-2009	«Ghantoot Development» Abu Dhabi. <ul style="list-style-type: none"> • Preliminary design of 3 bridges, 2 spans. • Preliminary design of a pedestrian bridge of 150m length. General arrangement drawings of the structural design.
GREECE (KANON CONSULTING S.A.)	2008-2009	Olympia Odos Concession Company S.A. Elefsina-Korinthos-Patra-Pyrgos-Tsakona Motorway Section GU 31N. Work included the final design and construction drawings for the following: <ul style="list-style-type: none"> • Overpass of 13.50m length CH. 76+379 and retaining walls. • Underpass of 10.50m length CH. 79+186, retaining walls. • Underpass of 13.50m length CH. 77+213 and pile retaining wall. Arrangement of reinforcement based on the results of the analysis, Reinforcement drawings and BBS tables.
GREECE (ODOTECHNIKI LTD)	2008–2009	Project Construction "Rehabilitation Works on the problematic sections of N.R. Tripoleos – Kalamata in the section: Paradisia – Tsakona", Peloponnese. Geotechnical and structural design of bridges, Cut & Covers, retaining walls etc. Head of the drawing department. General arrangement and reinforcement drawings of the structural design. Drawings of the geotechnical design.
GREECE (ODOTECHNIKI LTD)	2008	Highway Tripoli – Kalamata, Peloponnese. <ul style="list-style-type: none"> • Detailed final design of the bridge of left branch from CH. 1+895.27 to 2+046.90





- Detailed final design of the Alfios river bridge from CH. 0+823.80 to CH. 1+068.24.





Head of the drawing department.
 General arrangement, prestress and reinforcement drawings of the structural design. Drawings of the geotechnical design.



REPRESENTATIVE PROJECTS (CONTINUED)

Country	Date	Name and description of the project and duties
GREECE (ODOTECHNIKI LTD)	2008	<p>Project Construction "Rehabilitation Works on the problematic sections of N.R. Tripoleos – Kalamata in the section: Paradisia – Tsakona", Peloponnese.</p> <p>Rehabilitation of culverts. Design of new culverts and retaining walls.</p> <p>Head of the drawing department.</p> <p>General arrangement, interventions/retrofit measures and reinforcement drawings of the structural design.</p>
		
GREECE (ODOTECHNIKI LTD)	2008	<p>Project Construction "Rehabilitation Works on the problematic sections of N.R. Tripoleos – Kalamata in the section: Paradisia – Tsakona", Peloponnese.</p> <p>Design of viaduct from CH. 13+774.54 to 14+270.48</p> <p>Precast solution</p> <p>Head of the drawing department.</p> <p>General arrangement, prestress and reinforcement drawings of the structural design. Drawings of the geotechnical design.</p>
		
GREECE (ODOTECHNIKI LTD)	2008	<p>Highway Igoumenitsa – Preveza. Improvement of sections. Subsection 04.</p> <p>Design of structures, bridges, underpasses and walls. (conceptual, preliminary, final design)</p> <p>General arrangement and reinforcement drawings of the structural design.</p>
		



REPRESENTATIVE PROJECTS (CONTINUED)

Country	Date	Name and description of the project and duties
GREECE (ODOTECHNIKI LTD)	2008	<p>Highway Tripoli – Kalamata, Peloponnese. Final Design of the Railway Underpass at CH. 1+196.97. (composite deck) Head of the drawing department. General arrangement and reinforcement drawings of the structural design.</p> 
GREECE (COMPUTATIONAL DESIGN LTD)	2006-2008	<p>Costa Navarino – Navarino Dunes Messinia. Group of Luxury hotels and golf courses on the beach of Messinia in Romanos position (approximately 205.000m²). It includes two hotel units developed in five overground and two underground levels, Convention Center, Thalassotherapy, Golf Facilities, swimming pools and extensive landscaping with bearing structure of reinforced concrete with steel roofs of various shapes and openings (conceptual, preliminary, final design). General arrangement and reinforcement drawings of the structural design.</p> 
GREECE (ODOTECHNIKI LTD)	2007	<p>Highway Egnatia Odos, Section 2.4 "Arahtos – Peristeri". Temporary connection of Egnatia Highway from the exit of tunnel T8 with Highway Ioannina – Trikala Bridge at CH. 0+274.79 of total length 15.00m (final design) General arrangement and reinforcement drawings of the structural design.</p> 

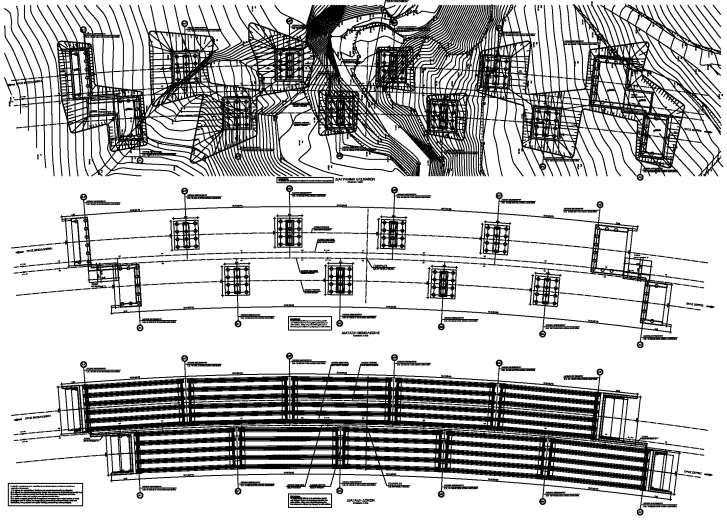

REPRESENTATIVE PROJECTS (CONTINUED)

Country	Date	Name and description of the project and duties
GREECE (ODOTECHNIKI LTD)	2007	<p>Railway line Korinthos – Patras, Entrance Akrata, Peloponnese.</p> <ol style="list-style-type: none"> 1) Three underpasses of span 10.50m – 11.50m. (final design) 2) Four bridges of total length 48.70m – 136.50m. (preliminary and final design) <p>General arrangement, prestress and reinforcement drawings of the structural design.</p> 
GREECE (ODOTECHNIKI LTD)	2007	<p>Highway Egnatia Odos, Section 60.1.1 "Derveni – Dorkada". Bridge G3 of total length 170.00m (Final Design)</p> <p>General arrangement, prestress and reinforcement drawings of the structural design.</p>  

REPRESENTATIVE PROJECTS (CONTINUED)

Country	Date	Name and description of the project and duties
GREECE (ODOTECHNIKI LTD)	2007	<p>Highway Pathe, section: "Skarfia – Rahe".</p> <ul style="list-style-type: none"> • Four underpasses of span 13.50m ÷ 20.50m. (preliminary and final design) • Overpass of total length 70.00m. (preliminary and final design) • Bridge of Vellias river of total length 105.50m. (preliminary design) • Tunnels T2, T7, T9 (final design) <p>General arrangement, prestress and reinforcement drawings of the structural design. Drawings of the geotechnical design.</p> 
GREECE (AMTE S.A.)	2006	<p>Cement factories «INTERBETON» New Concrete Production Unit. Structural design of industrial concrete buildings. Arrangement of reinforcement based on the results of the analysis, Reinforcement drawings and BBS tables.</p>
GREECE (AMTE S.A.)	2006	<p>Power plant P.P.C. Unit III (Public Power Corporation) Final design stage of the following:</p> <ul style="list-style-type: none"> • Recycle Pumps Building. • Absorder and Staircase Tower. <p>Arrangement of reinforcement based on the results of the analysis, Reinforcement drawings and BBS tables.</p>
GREECE (COMPUTATIONAL DESIGN LTD)	2005	<p>Rehabilitation Works of N.R. Gastouni – Bartholomiou. Final design of Viaduct with total length 122.00m and three spans at CH. 0+348.62 (prestressed deck). General arrangement, prestress and reinforcement drawings of the structural design.</p> 

REPRESENTATIVE PROJECTS (CONTINUED)

Country	Date	Name and description of the project and duties
GREECE (COMPUTATIONAL DESIGN LTD)	2004-2005	<p>National Road Elassona – Larisa</p> <p>Final design of the following:</p> <ul style="list-style-type: none"> • Underpass of span 14.00m at CH. 0+564.62 • Viaduct with total length 110.00m and three spans at CH. 1+360.75 (prestressed deck). • Viaduct with total length 88.00m and three spans at CH. 4+849.12 (prestressed deck). <p>General arrangement, prestress and reinforcement drawings of the structural design.</p>
GREECE (COMPUTATIONAL DESIGN LTD)	2003-2004	<p>National Road Hraklio – Ag.Deka – Biannos – Ieraptra, Section Ag. Barbara – Apomarma.</p> <p>Final design of the following:</p> <ul style="list-style-type: none"> • Viaduct with total length 210.00m and six spans (prestressed deck).  <ul style="list-style-type: none"> • Viaduct with total length 245.00m and seven spans (prestressed deck). 
GREECE (COMPUTATIONAL DESIGN LTD)	2002-2004	<p>Gym in Chania, Crete.</p> <p>Final structural design of the Gym and the surrounding area</p> <p>The Gym has external dimensions 69.80m x 64.60m.</p>  <p>General arrangement and reinforcement drawings of the structural design.</p>



REPRESENTATIVE PROJECTS (CONTINUED)

Country	Date	Name and description of the project and duties
GREECE (COMPUTATIONAL DESIGN LTD)	2003	«Completion of Afchin Agkathias – Chamezi – Siteia». Viaduct curved in plan-view, with a total length of over 840.0m and twenty one spans. General arrangement, prestress and reinforcement drawings of the structural design.
GREECE (COMPUTATIONAL DESIGN LTD)	2002-2003	Health center in Kalivia, Athens. Final structural design of a building with an area in plan-view of 2.500m ² . General arrangement and reinforcement drawings of the structural design.
GREECE (COMPUTATIONAL DESIGN LTD)	2000-2002	Hotel KING GEORGE in Athens. Design verification study and strengthening of the building. General arrangement and reinforcement drawings of the structural design.
GREECE (COMPUTATIONAL DESIGN LTD)	2000-2001	Gym at the Municipality of Kozani, of external dimensions 53.65mx64.65m. Final structural design of the indoor gymnasium and layout of the immediate surroundings. General arrangement and reinforcement drawings of the structural design.
GREECE (AMTE S.A.)	2000	Cement factories "TITAN" Unit 4, Thessaloniki. Final structural design of the following: <ul style="list-style-type: none"> • New clinker production unit. • Installation of cement mill No6. • Transportation and storage of cement. Arrangement of reinforcement based on the results of the analysis, Reinforcement drawings and BBS tables.
GREECE (AMTE S.A.)	1998-2000	Florina Power Plant P.P.C. (Public Power Corporation) Final structural design of the following: <ul style="list-style-type: none"> • Turbine house. • Cooling tower. • Bunker house. • Boiler house. • Waste water treatment plant. • Crusher house. • Raw water storage and pump house. • Diesel oil storage tank & unloading station. • Auxiliary boiler house.



Arrangement of reinforcement based on the results of the analysis, Reinforcement drawings and BBS tables.

REPRESENTATIVE PROJECTS (CONTINUED)

Country	Date	Name and description of the project and duties
GREECE (AMTE S.A.)	1995-1998	<p>Athens International Airport «Eleftherios Venizelos».</p> <p>Final structural design of the following:</p> <ul style="list-style-type: none"> • Main Terminal. • Office building HOCHTIEF. • Parking short and long term • Composite bridge <p>Arrangement of reinforcement based on the results of the analysis, Reinforcement drawings and BBS tables.</p> <p>As built: adjustment and updating of the architectural drawings after the construction of the shops in the Main Terminal.</p> 
GREECE (AMTE S.A.)	1996	<p>Lavrio Power Plant P.P.C. (Public Power Corporation)</p> <p>Final structural design of the following:</p> <ul style="list-style-type: none"> • Gas turbine hall. • Steam turbine hall. • Pipe rack. • Electrical building for gas turbine hall. <p>Arrangement of reinforcement based on the results of the analysis, Reinforcement drawings and BBS tables.</p>
GREECE (AMTE S.A.)	1995	<p>Gas Facilities in Revithoussa</p>  <p>Work included the final structural design and construction drawings for the following:</p> <ul style="list-style-type: none"> • Administration building. • Maintenance building. • Control building. • Diesel generator building. <p>Arrangement of reinforcement based on the results of the analysis, Reinforcement drawings and BBS tables.</p>

REPRESENTATIVE PROJECTS (CONTINUED)

Country	Date	Name and description of the project and duties
GREECE (AMTE S.A.)	1995	Oil facilities in Libya Final structural design of industrial units (i.e. oil tanks, pipe racks etc) Arrangement of reinforcement based on the results of the analysis, Reinforcement drawings and BBS tables.
GREECE (AMTE S.A.)	1995	Agios Dimitrios Power Plant P.P.C. (Public Power Corporation) Chimney 220m height (Final structural design). Arrangement of reinforcement based on the results of the analysis, Reinforcement drawings and BBS tables.

